



H-grade
http://www.highgrade.com.tw

Model Name:AUW10
Issus Date:2022/06/22(A)

Complete System

Net Weight	1.8 kg (3.97 lbs)
Dimension(W*H*D)	410 x 370.5 x 111mm (16.14" x 14.59" x 4.37")
Screw Type	M4
Material	Steel/Aluminum Alloy/Plastic

Display System

Hinge Module	Swivel(Hinge)	+/-90°
	Tilt(Hinge)	+/-20°
	Pivot	360°
	User Torque Adjust	Available
Display Support	Mounting Pattern	100x100 / 75x75 mm
	Flat Panel size support	≤34"
	Flat panel support weight (range)	4-12 kg (8.82-26.46 lbs)
	Curved Panel size support	≤34"
	Curvature	≥1000R
	Curved panel support weight (range)	4-7.5 kg (8.82-16.53 lbs)
Height Adjust	Height Adjustment Range (Arm)	315 mm (12.4")
	Tension Torque Adjust	Yes
	Tilt(Arm)	-30°(down) ~ +65°(up)
Max. Distance To The Wall	410mm (16.14")	
Min. Distance To The Wall	111mm (4.37")	
Extended Arm Provided	1	
Cable Management	Yes	

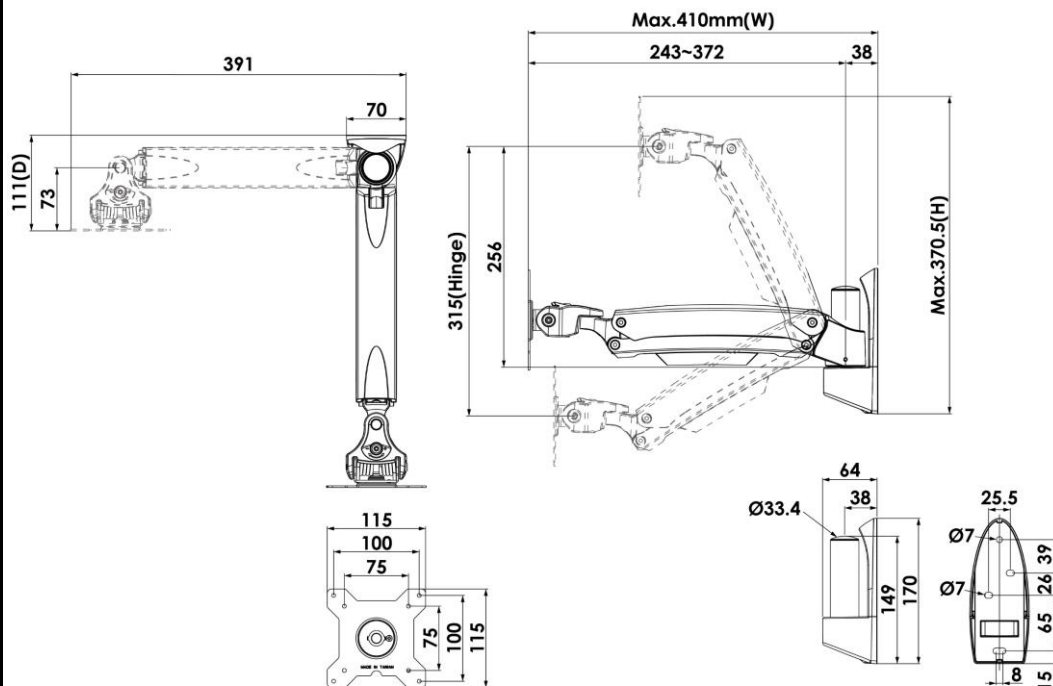

≤ 34"	≤ 34"	≥1000R
4-12 kg	4-7.5 kg	
8.82-26.46 lbs	8.82-16.53 lbs	
MONITOR	CURVED	

VESA	Tilt	Rotate	Swivel	Cable Management	Height Adjust	Torque Adjust
100x100 75x75(mm)	+20° -20°	360°	±90°		+65° -30°	