

Model Name:AUW20
Issus Date:2022/06/22(A)

Complete System

Net Weight	2.2 kg (4.85 lbs)
Dimension(W*H*D)	610 x 452 x 110 mm (24.01" x17.79" x 4.45")
Screw Type	M4
Material	Steel/Aluminum Alloy/Plastic

Display System

Hinge Module	Swivel(Hinge)	+/-90°
	Tilt(Hinge)	+/-20°
	Pivot	360°
	User Torque Adjust	Available
Display Support	Mounting Pattern	100x100 / 75x75 mm
	Flat Panel size support	≤34"
	Flat panel support weight (range)	4-12 kg (8.82-26.46 lbs)
	Curved Panel size support	≤34"
	Curvature	≥1000R
Height Adjust	Height Adjustment Range (Arm)	315 mm (12.4")
	Tension Torque Adjust	Yes
	Tilt(Arm)	-30°(down) ~ +65°(up)
Max. Distance To The Wall	610 mm (24.01")	
Min. Distance To The Wall	110 mm(4.33")	
Extended Arm Provided	2	
Cable Management	Yes	

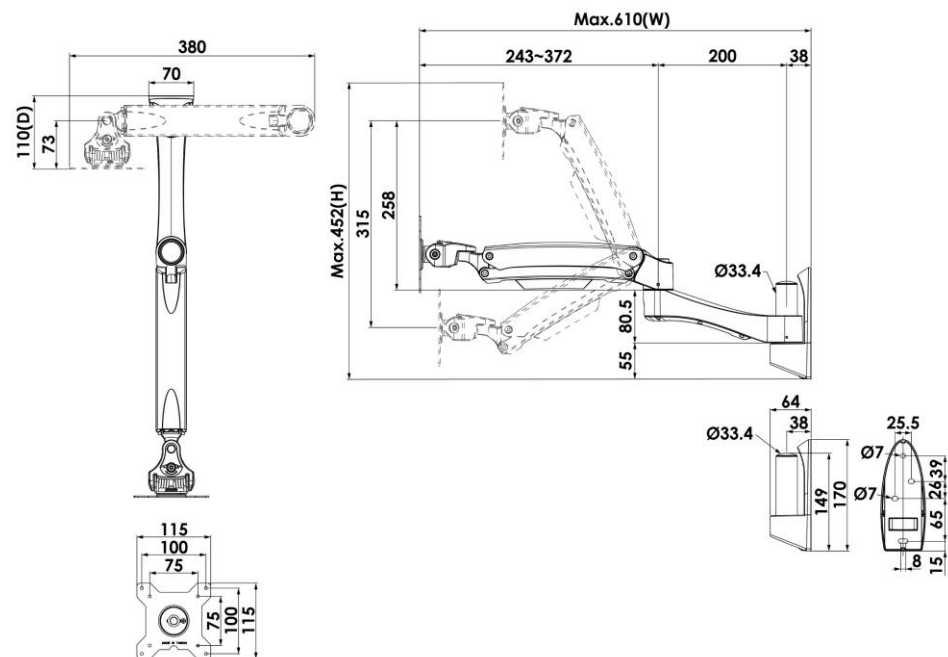

≤ 34"	≤ 34"	≥ 1000R
4-12 kg	4-7.5 kg	
8.82-26.46 lbs	8.82-16.53 lbs	
MONITOR	CURVED	

VESA	Tilt	Rotate	Swivel	Cable Management	Height Adjust	Torque Adjust
100x100 75x75(mm)	+20° -20°	360°	±90°		+65° -30°	